

## RS485 Module Installation Guide

### Pin location and functions:

Pin Location	Description	Function
1	CT-	Power limit
2	CT+	Power limit
3	External signal	For CEI 0-21
4	Remote off signal	
5	GND	+5V DC Source
6	+5V	
7	2B	
8	2A	
9	1B	RS485
10	1A	
	KEY	WiFi Password Reset

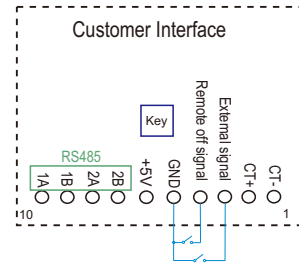

- 1** Check the red switch.  
Turn the red switch to "1" for these interfaces from No.1 to NO.N-1, and yet turn the red switch to "ON" for No.N interface.

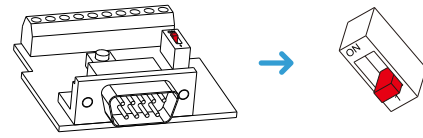

### RS485 Installation Steps:

Connecting RS485 interface is shown in below picture:

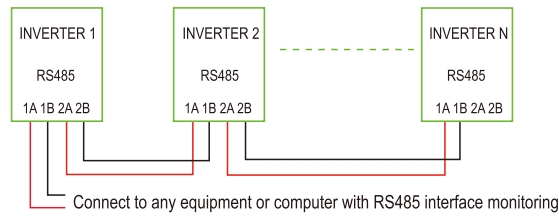

- 2** Remove the plate.

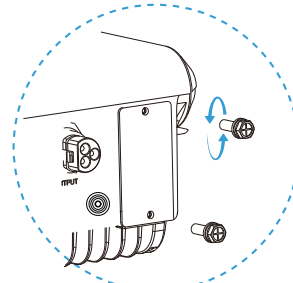

- 3** Remove the two waterproof connectors on the cover; Thread the cable through the waterproof connectors.

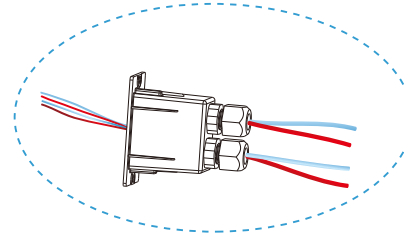

- 5** Connect RS485 board to RS232 terminal with component side facing the left, Then insert the shell into the guide slot according to the trend.

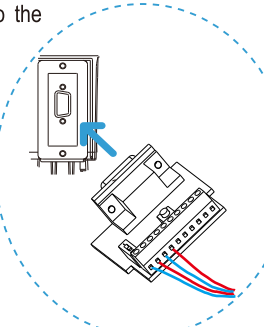

- 4** The wiring is marked "1A/1B/2A/2B", corresponding to 10, 9, 8 and 7 feet locked in CN1 (about 5mm wire peeling).

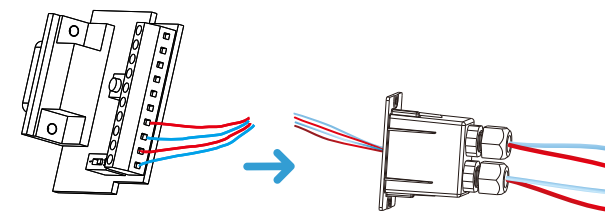

- 6** Lock the cover, and tighten the screws.

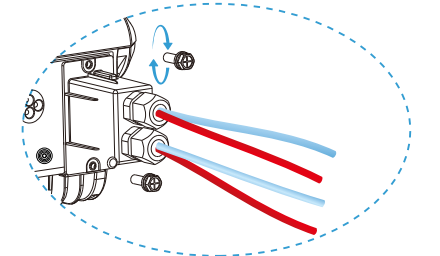

- 7** Tighten the waterproof connector.

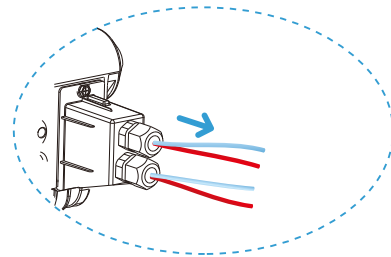

- 9** WIFI Connection Method for Android System:  
Choose Settings > WLAN on your mobile phone and click the WIFI with the name of inverter serial number and enter password (Default 12345678) to link to the WIFI module.  
Open App and choose Local Setting, click Inverter to login.

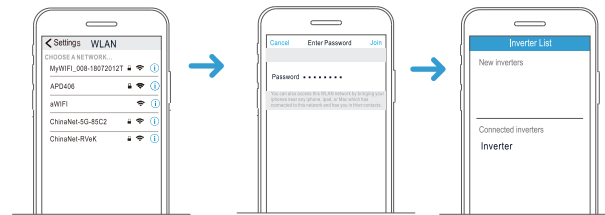

- 11** Check the Modbus address in below Figure, the default address is 1, click the revisable address, revise the address and save it.

The default address is 1, which can be modified according to the actual circumstance. The recommended modify value is 1-247.

Address must be unique for the inverter having the same RS485 with other inverters.

**Note:**

If other functions are needed, finish all the wiring you need before steps ⑤, ⑥ and ⑦.

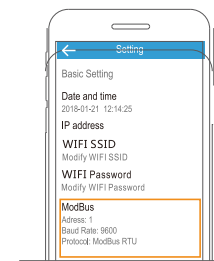

- 2** Referring to the steps ③ and ④ of RS485 installation, connect the cables to pins "5, 6" of CN1, and mark them with "+5V/GND".

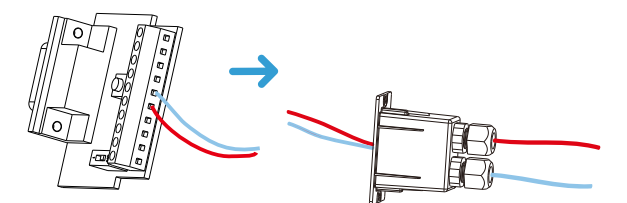

- 8** Scan the QR code (See the Quick Installation Guide) with your phone to download the APP, and connect the inverter for local connection (See the Accessory Installation Guide for reference).

- 10** Press the extended-key icon on the APP home page, select Settings icon from the menu popped up.

The extended-key is the icon "..." on the APP home page.

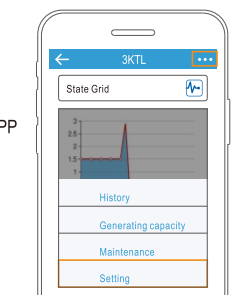

### Using +5V DC Source Function:

- 1** Note:  
Output voltage and range : +5V ± 10%  
Full load : 0.1A

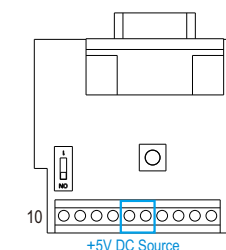

- 3** Referring to the steps ⑤, ⑥ and ⑦ of RS485 installation.

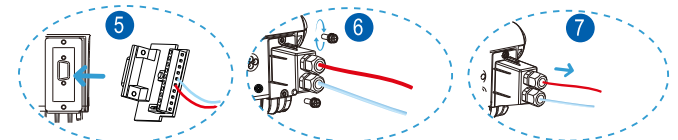

**Using CEI 0-21 Function:**

- 1 Customer Wiring: Connect a switch named "SW1" between cables marked with "ROS" and "GND", a switch named "SW2" between cables marked with "ES" and "GND".

Close "SW1" to enable the "Remote off signal"  
Close "SW2" to enable the "External signal"

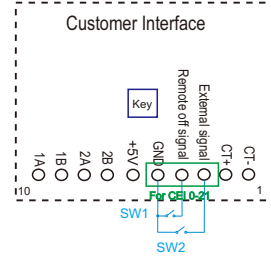

- 3 Referring to the steps ⑤, ⑥ and ⑦ of RS485 installation.

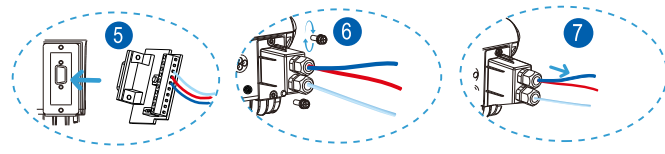

- 2 Referring to the steps ③ and ④ of RS485 installation, connect the cables to pins "3, 4, 5" of CN1, mark them with "GND, ROS, ES".

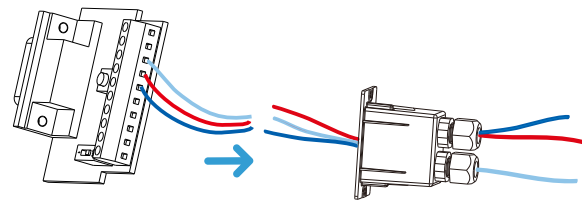

5

**Using Power Limit Function:**

- 1 Note: This function is only provides the current sensing wiring interface, it will work only when power limit function is supported in the inverter.

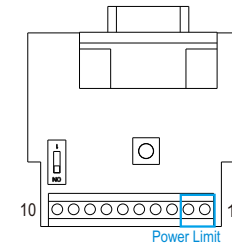

- 2 Referring to the steps ③ and ④ of RS485 installation, connect the cables to pins "1, 2" of CN1, mark them with "CT+, CT-".

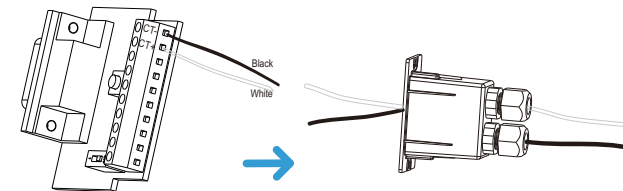

- 3 Referring to the steps ⑤, ⑥ and ⑦ of RS485 installation.

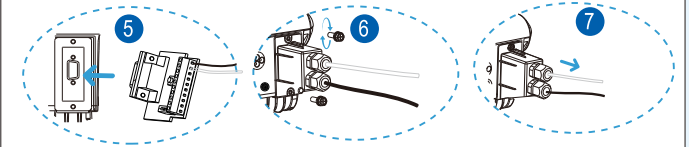

- 4 Press the extended-key icon on the APP home page, select "Power Limit".

**Digital meter Type**

- 1) Power limit function
- 2) Power limit mode
- 3) Digital meter power direction
- 4) Power limit CT ratio

6

- 1) "Power limit function"

Select "CT Sensor"

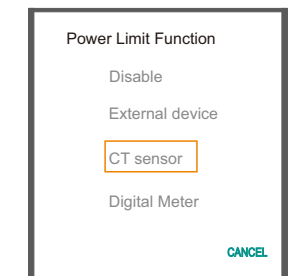

- 3) "Digital meter power direction"

If the direction of CT Current is the same as shown in the picture, select "Positive".  
If not, select "Negative".

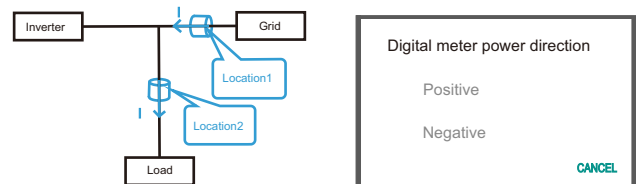

- 2) "Power limit mode"

Location 1 : select "CT/meter on Grid"  
Location 2 : select "CT/meter on Load"

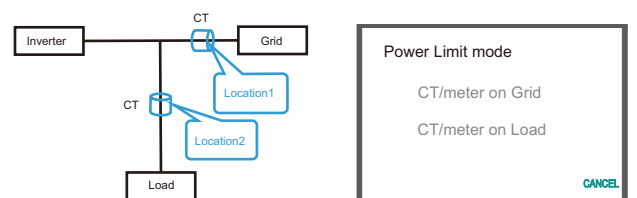

- 4) "Power limit CT ratio"

Select the ratio according to CT Specification.

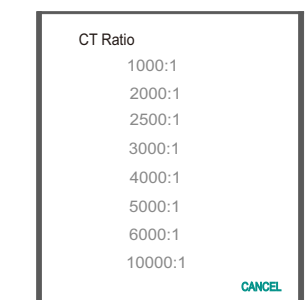

7

**Using the WIFI Password Reset Key:**

- 1 Release the waterproof connectors.

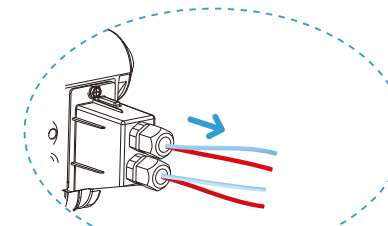

- 3 Press the key "K1" for at least 1s, the WIFI password will be reset successfully. Make sure the RS232 interface is connected before pressing And then assemble them back following the steps ⑥ and ⑦ of the RS485 installation.

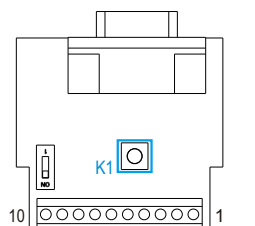

- 2 Release the screws, remove the plastic cover.

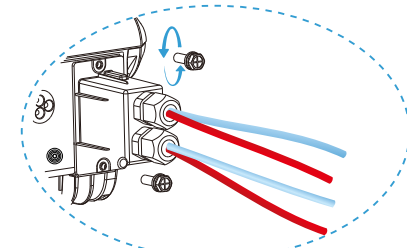

8